

University Rowing Association Championship Regatta

Saturday, April 2, 2016

Location: Eagle Creek Park at the Indianapolis Rowing Center northwest of Indianapolis (Address: 7350 Eagle Beach Dr, Indianapolis, IN 46254). Venue information can be found at: <http://www.universityrowing.com/venue.html> and information about the state park can be found at: <http://www.indy.gov/eGov/City/DPR/ECPark/Pages/default.aspx>

Competition: This event is an invitational regatta for university club crew programs whose varsity sports programs compete at the NCAA Division III level. Participants for each team must be bona fide members of that university's club crew program. Crew clubs are invited this year from those universities whose varsity athletic programs compete in the University Athletic Association (UAA). Invited programs include:

- Brandeis University
- Case Western Reserve University
- Carnegie-Mellon University
- University of Chicago
- Emory University
- New York University
- University of Rochester
- Washington University

However, this event is not officially sanctioned nor recognized by the UAA or NCAA.

Regatta Web Site: <http://www.universityrowing.com/> <<<<< **Check for latest information**

Registration and Entry Information: All entries will be made through the Regatta Organizer (see below). Please try and provide your final entry information on or before **noon** on Tuesday, March 29th, 2016 (so we can distribute a preliminary race schedule). *There tends to be a bunch of adjusting of the race day schedule leading up to the race to accommodate hot seating. The sooner you can send in your entries the better.* Email or phone entries are acceptable.

We are going to attempt to have **no cash entry fees** this year. In lieu of cash, crews will be expected to bring shirts for betting and teams should be willing to provide volunteers throughout the day for various duties. Shirts can be exchanged after each race or during the awards ceremony at the end of the day. Bring extra shirts if you'd just like to swap as well.

Directions:

Indianapolis Rowing Center (IRC) is located in Eagle Creek Park on the Northwest side of Indianapolis. The facilities include a large pole barn that houses private boats, club boats, and boats belonging to area colleges. There are on-site showers and restroom facilities, as well as the coach's office. The boathouse is open March- November.

The boathouse is located at **7350 Eagle Beach Drive, Indianapolis, IN 46254**. The boathouse phone number is 317-298-9456.

The 2,000-meter course on Eagle Creek Reservoir was the site of the rowing events for the 1987 Pan-Am Games, the 1994 World Rowing championships and has hosted USRowing National Championship Regattas 16 times since 1987. The Indianapolis Rowing Center also hosts high school and collegiate regattas in the spring and the Head of the Eagle each October.

Driving Directions to the Indianapolis Rowing Center boathouse and regatta site:

From the north:

1. Take Lafayette Rd. south.
2. Turn right (west) onto 56th St.
3. Pass I-465.
4. Turn right (north) into Eagle Creek Park.
5. Skip to instruction "A", below.

From the south:

1. Take I-465 West (If you have a choice of only North or South, go North! The point is to avoid traveling East around the beltway, because the park is on the west side of Indianapolis).
2. Exit at 56th St.
3. Turn left (west) onto 56th St.
4. Turn right (north) into Eagle Creek Park.
5. Skip to instruction "A", below.

From the west:

1. Take 56th St. east.
2. Turn left (north) into Eagle Creek Park.
3. Skip to instruction "A", below.

From the east:

1. Take 56th St. west.
2. Go past Lafayette Rd.
3. Pass I-465.
4. Turn right (north) into Eagle Creek Park.

From the 56th St. park entrance:

- A. Take the first left, toward the beach and water sports area.
- B. Take the first right ("Water sports"), onto a short gravel road through the woods and the gate of the center.

Trailer Parking: Ample parking is available in Eagle Creek Park near the Indianapolis Rowing Center inside the gates to the boathouse site. Spectators should use the paved parking lots outside of the boathouse grounds. Eagle Creek Park opens at 7am and there is a \$6 entry fee for cars and \$15 for buses.

We are racing in a State Park, so every team should take care to not leave trash or damage the site in any way.



Eagle Creek Racing Lanes

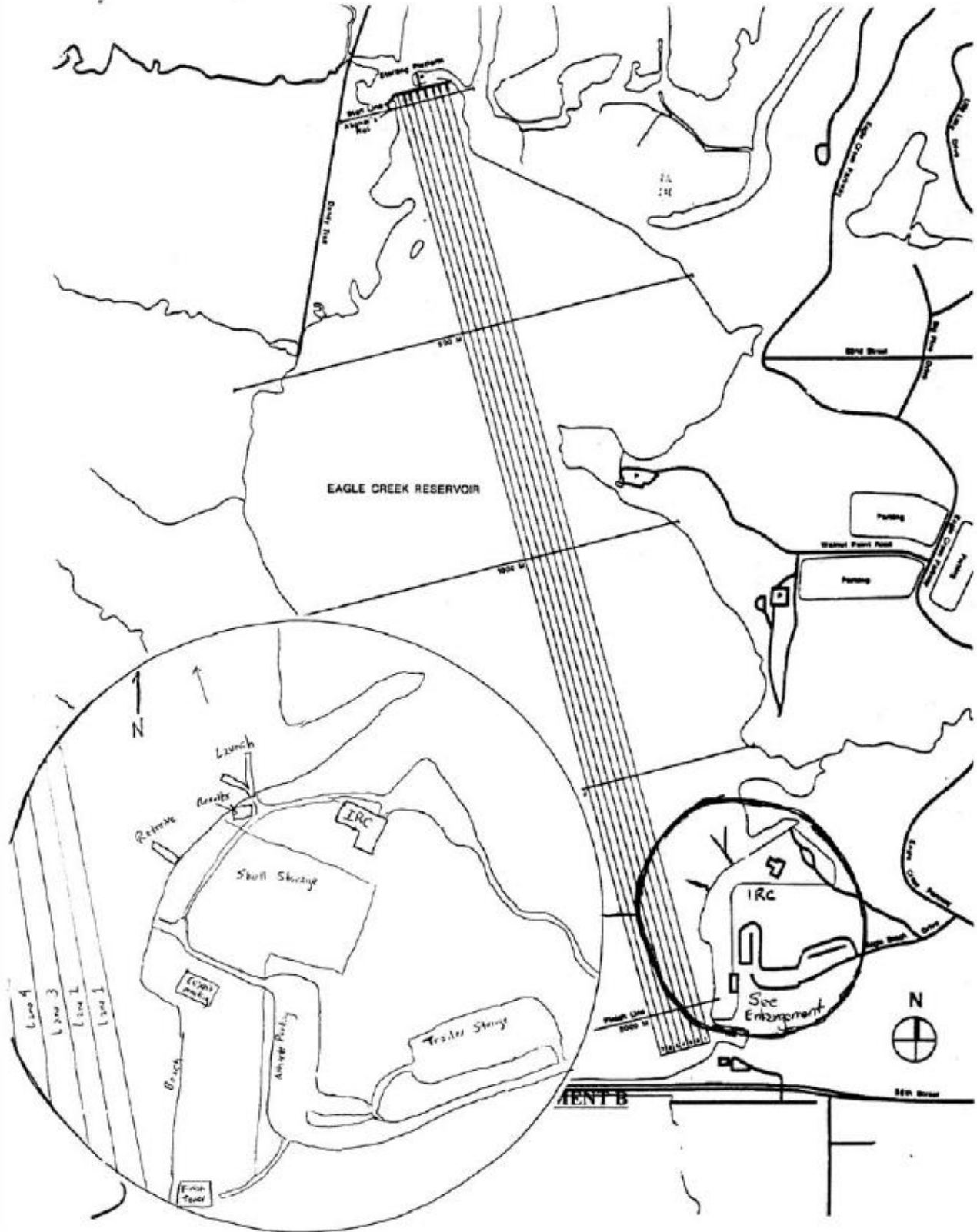

Check in: Will begin April 2nd, 2016 at about 7:15am. Please check in at the registration stand upon arrival. **Waivers (standard USRowing) should be brought to the race and delivered upon checking in. Participation in this event is an acceptance of associated risk and each team is to supply their own event insurance to participate in this scrimmage.**

Coaches and coxswains: Coach/Coxswain meeting will be held April 3rd, 2011 at 7:30am. Races will begin launching as close to 8:00 am as possible. A heat sheet and updated race schedule will be provided at the meeting. Coxswains will not be weighed.

JV & 2nd Crews: A Junior Varsity (JV) crew may not enter the open/varsity event of the same boat class. Similarly with the novice events if two flights of the same novice boat class are offered. Generally, the fours are oversubscribed since coaches want to race multiple fours in an event. When entries warrant, we will try and offer a separate JV/2nd boat event that will receive medals but no points (see "Team Points" appendix). Otherwise, the second crews will fill out the field of the Varsity or Lightweight events. As a result, a rower competing in the JV or second novice event may not compete in another, higher category of that boat class. E.g. if a rower is in the JV four, they may not enter the varsity four, but can race in the open eight or open pair event.

Lightweights: will be based on the honor system with no individual male rower exceeding 160lbs or female rower exceeding 130lbs. Athletes will not be weighed on the day. If a rower/coach is found to have violated the honor system, the offending crew will be disqualified. Suspect rowers may be asked to weigh in at any point during the day.

Novice: A Novice event is open to rowers in their first year of any competition. Novice status is separate for sweep and sculling. Crews entered in Novice events shall include only novice rowers. A novice coxswain is not required to cox a novice entry.

Singles: The 1x event is for exhibition. Coaches, grad students, anyone affiliated with your school is encouraged to enter. We'd like to run the race first to help test all of the regatta infrastructure. Medals will be given to the top three finishers. However, only scullers that are bona fide members of the team will count for team points.

All teams will need to provide their own bow numbers. Lanes 0-7 <<<<<<<

Lodging: Ample lodging can be found in and around Indianapolis.

Course/Awards: The course will be 2000 meters long (5 lanes) and will begin with a floating start. Medals (gold, silver & bronze) will be awarded for each race including the "B" crew finals. The men's and women's teams will compete for the overall point cups will be based on the agreed upon scoring system (see Appendix 1). In the tradition of collegiate championship racing, crews are expected to give their racing shirts to the winners of the event in which they participated. This practice is expected, but not mandatory this year. Currently, the annual regatta challenge cups are:

- | | |
|---------------------------|--|
| Chicago Alumni Cup | Women's Team Point Champions |
| Case Alumni Cup | Men's Team Point Champions |
| Milikowsky Cup | Men's Lightweight Four Champions |
| Barry Cup | Women's Novice Eight Champions |
| Kesten Cup | Men's Novice Four Champions |
| Rathburn Cup | Men's Pair without Coxswain Champions |

There will be an awards presentation at the end of the day for individual event medals and the team point trophies. Rowers can take this opportunity to swap their betting shirts. Please, ensure your teams stick around for the presentation. We will be taking event and team photos.

Previous Cup Winners:

<http://www.universityrowing.com/result.html>

Chicago Alumni Cup – *Women’s Team Point Champions*

2011	University of Rochester
2010	University of Rochester
2009	University of Rochester
2008	University of Rochester
2007	Washington University in St. Louis
2006	Washington University in St. Louis
2005	University of Rochester
2004	University of Rochester

Case Alumni Cup – *Men’s Team Point Champions*

2011	University of Rochester
2010	Washington University in St. Louis
2009	Emory University
2008	Washington University in St. Louis
2007	Washington University in St. Louis
2006	Washington University in St. Louis
2005	University of Rochester
2004	Washington University in St. Louis

Barry Cup – *Women’s Novice 8+ Winner*

2011	University of Rochester
2010	University of Rochester
2009	Washington University in St. Louis

Milikowsky Cup – *Men’s Lightweight 4+ Winner*

2011	Carnegie-Mellon University
2010	Washington University in St. Louis
2009	Washington University in St. Louis
2008	Washington University in St. Louis
2007	Washington University in St. Louis

Kesten Cup – *Men’s Novice 4+ Winner*

2011	University of Rochester
2010	University of Rochester
2009	Washington University in St. Louis

Rathburn Cup – *Men’s Open Pair Winner*

2011	University of Rochester
2010	University of Rochester
2009	University of Rochester
2008	Washington University in St. Louis

Tentative Regatta Schedule*: (all events are finals until further notice)

Please, be aware that the race times are local. Pittsburgh is on Eastern Time. Race times are at the starting line – plan to launch ~30min before.

Please check <http://www.universityrowing.com/regatta/2016/schedule.html> for latest schedule

8:30am	Exhibition	Open 1x	
9:00 am	Event 1	Women's Varsity & JV 8+	
9:40 am	Event 2	Men's Novice 4+	Kesten Cup
	30 Minute BREAK		
10:20 am	Event 3	Men's Varsity & JV 8+	
10:30 am	Event 4	Women's Novice 4+	
	30 Minute BREAK		
11:10 am	Event 5	Women's Varsity 2-	
11:20 am	Event 6	Men's Novice 8+	
	30 Minute BREAK		
12:00 am	Event 7	Men's Varsity 2-	Rathburn Cup
12:10 am	Event 8	Women's Novice 8+	Barry Cup
	30 Minute BREAK		
12:50 am	Event 9	Women's Varsity 4+	
1:00 pm	Event 10a	Men's Lightweight 4+	Milikowsky Cup
	Event 10b	Men's JV 4+	
	30 Minute BREAK		
1:40 am	Event 11	Women's JV/Ltwt 4+	
1:50 am	Event 12	Men's Varsity 4+	

* Please send requests for changes in the schedule ASAP

Due to expected number of entries, we will probably offer finals for A & B crews with medals given for each. The schedule will be finalized once all entries are received (please, check your email inbox frequently the week before the race).

There is plenty of time between races this year. Coaches must do their best to ensure their crews are near the starting line 2 minutes before the start of the event. Crews late to the start will be assessed a false start. Crews with 2 false starts may participate in the race for time only, but will not be considered for awards or the team point standings.

Rules and Arbitration: This is a race organized for the benefit of the student athletes by the coaches and school supporters. The race is meant as an early season tune up for the participating schools and is informal in nature. Since the race is run by and for the schools, coaches with the help of the officiating staff will be responsible for settling any disputes in a sportsmanlike manner. Let's all enjoy a great day of racing.

Launching/Course: The regatta site has ample dock space. The expectation is that there will be lots of **hot seating** (shells and rowers) throughout the day. There will be plenty of time between races so it is each crew's responsibility to report to the starting area on time. Since ample time will be given, late crews will be assessed a false start if late to the start. All crews must arrive at the dock with their correct bow numbers.

Launch with bows away from shore and return with bows toward shore.

Volunteers: Each team is expected to provide at least two people to be available for volunteer duties throughout the day. As last year, head coaches will take a leadership role in the regatta and be

responsible for the major portions of the regatta operation. Support volunteers are to report to the check-in area at 6:00am on race day. Coaches will be running around in a crazed manner per the usual...

Major Areas of Responsibility:

Start Line – 2 or 3 head coaches + 4 volunteers for starting and launch duty

Finish Line – 1 head coach + 8 volunteers for timing and finish arbitration

Dock – 1 head coach + 3 volunteers for aiding crews and tracking hot seating

Regatta Organizer Contact Information:

Doug Rathburn

1492 Antler Ct., Bettendorf, IA 52722

(m) 216-777-9670 doug@rathburn.net

Appendix 1

Team Points Scoring System

The following points system was adopted in 2010 and is used to award the team points trophies: **Chicago Alumni Cup** for women and **Case Alumni Cup** for men.

Points will be calculated in each event for the highest scoring entry for each team in the final. Multiple entries from any team are permitted in an event. An "official event" is defined as two or more varsity designated (including varsity lightweight) crews from different universities or four or more JV/B crews from different universities. Official events will receive points toward the team trophies. If a heat/flight does not meet the "official event" criteria crews will receive medals, but no points.

Events may be combined to reduce the number of flights required during race day. If two official events are run at the same time (e.g. four V8 and four JV8 crews in the same flight) they will be awarded points and medals as if separate. However, if there are less than four JV/B crews combined into an official varsity event only the highest placing boat will earn points. (e.g. four V8 and two JV8 crews with university "X" taking 1st and 3rd -- both receive medals and only 1st receives points).

Tie breakers for the team trophies will be decided by results in highest level head-to-head race between the universities that tied based on the following priority: V8, V4, Lt4, N8, V2, N4, V1

Point Methodology

Points available per entry:

V8	JV8, Lwt8, N8	V4	V2, N4A, JV4, Ltwt4	V1, JV2, N4B
5	4	3	2	1

Calculation for awarding points:

(Number of Crews Beaten in Event + 1) * Points Available for that Event from above Table

Examples

Example for 8 finishers in an event:

Place	V8	JV8, Lwt8, N8	V4	V2, N4A, JV4, Ltwt4	V1, JV2, N4B
1st	40	32	24	16	8
2nd	35	28	21	14	7
3rd	30	24	18	12	6
4th	25	20	15	10	5
5th	20	16	12	8	4
6th	15	12	9	6	3
7th	10	8	6	4	2
8th	5	4	3	2	1

Example for 4 finishers in an event:

Place	V8	JV8, Lwt8, N8	V4	V2, N4A, JV4, Ltwt4	V1, JV2, N4B
1st	20	16	12	8	4
2nd	15	12	9	6	3
3rd	10	8	6	4	2
4th	5	4	3	2	1

Points will be awarded in Varsity (Open and Lightweight) events with 2 or more entrants from different universities. For JV and Novice B crews to be awarded points there must be 4 or more entrants from different universities in the race.